



Talman Grove

Stanmore

£799,999

A five bedroom, link detached house with almost 2000 square feet of space on a quiet, residential, no-through road in central Stanmore.

On the ground floor is a large, open plan kitchen/dining/family room with bi-folding doors offering brightness to the room and access to a low-maintenance rear garden with patio, artificial grass and a relaxing pond. In addition there is a study, utility room, integrated garage, downstairs WC and a separate, bay-windowed, formal reception room.

On the first floor is the master bedroom with views over the garden, walk-in wardrobe and ensuite bathroom. There are two further bedrooms on this floor along with a family bathroom. On the top floor are two further bedrooms, another bathroom and lots of eaves storage.

The front of the house provides off-street parking for two or three cars. Talman Grove is within a quarter of a mile of North London Collegiate School and half a mile of Stanmore Tube Station, as well as the shops, cafes and amenities in central Stanmore.

Harrow Council Tax Band F.

Viewing

Please contact our Davidson Frost-Wellings Office on 020 8954 8806 if you wish to arrange a viewing appointment for this property or require further information.

- Five Bedrooms
- Three Bathrooms
- Low Maintenance Garden
- Chain Free
- Excellent Location
- Link-Detached Freehold



Floor Plan

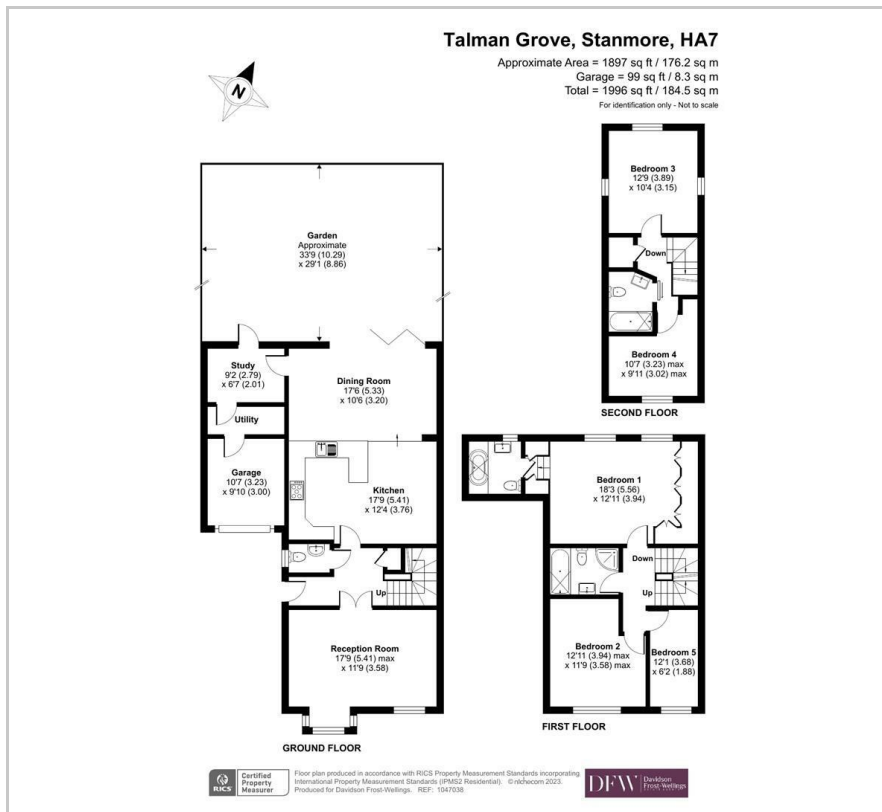

Area Map

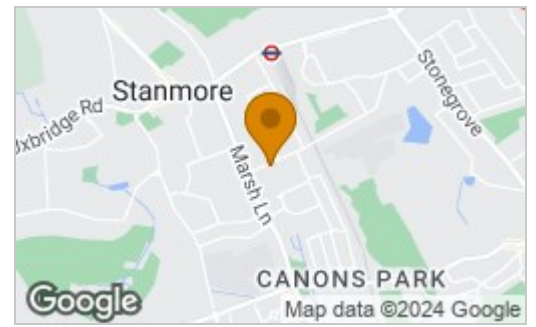

Energy Efficiency Rating

	Current	Potential
Very energy efficient - lower running costs		
(92 plus) A		
(81-91) B		
(69-80) C	72	80
(55-68) D		
(39-54) E		
(21-38) F		
(1-20) G		
Not energy efficient - higher running costs		
England & Wales	EU Directive 2002/91/EC	



These particulars, whilst believed to be accurate are set out as a general outline only for guidance and do not constitute any part of an offer or contract. Intending purchasers should not rely on them as statements of representation of fact, but must satisfy themselves by inspection or otherwise as to their accuracy. No person in this firm's employment has the authority to make or give any representation or warranty in respect of the property.